

# ARKANSAS

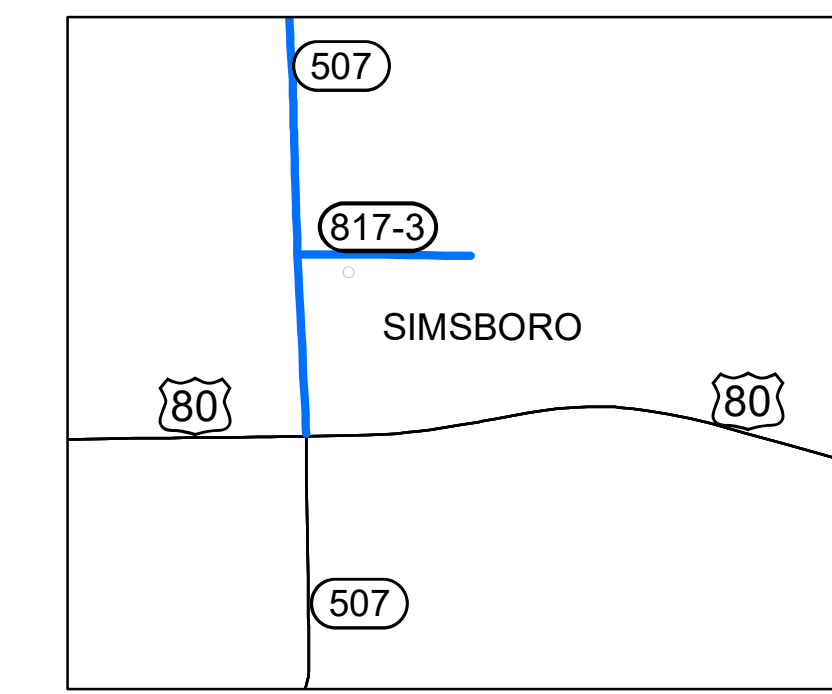

SIMSBORO

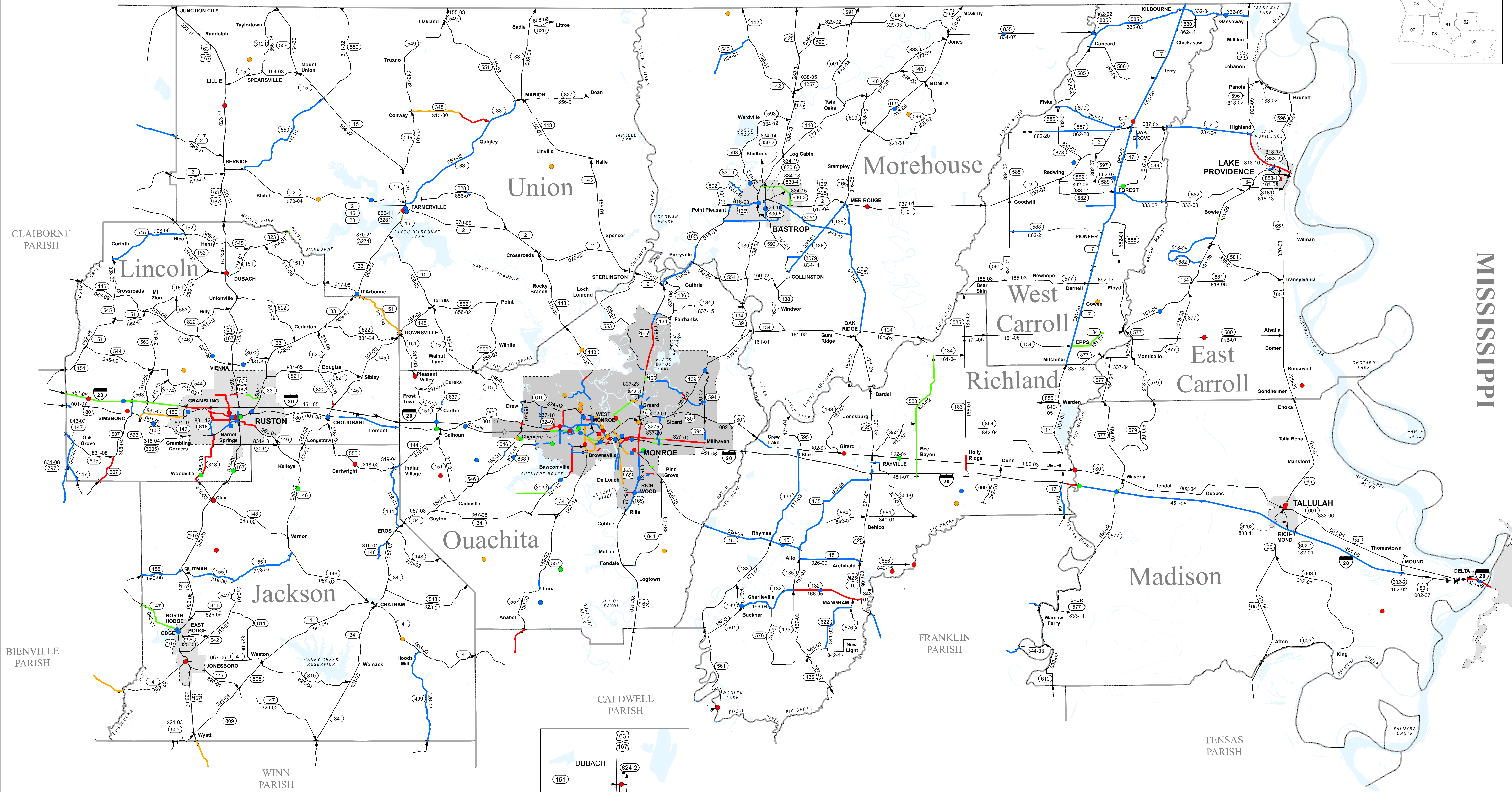
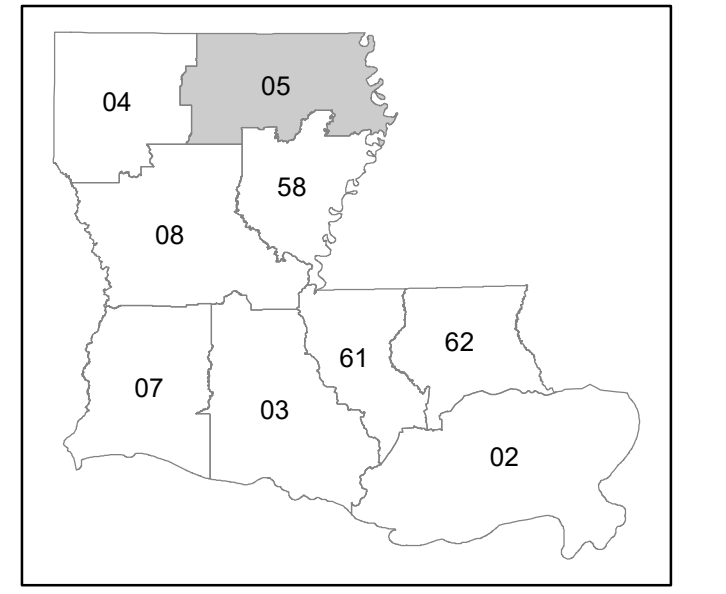
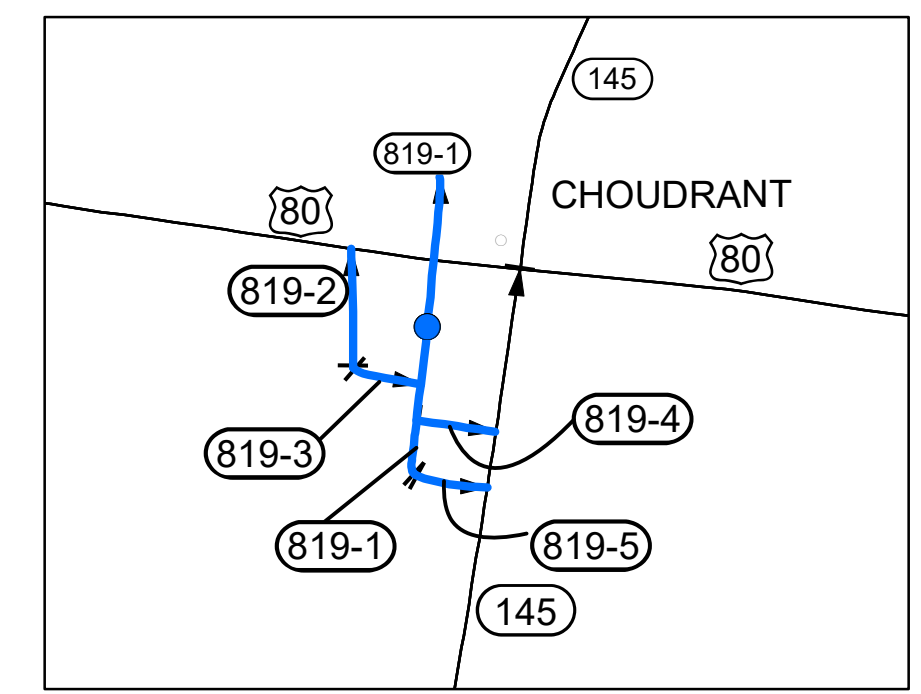

CHOUDRANT

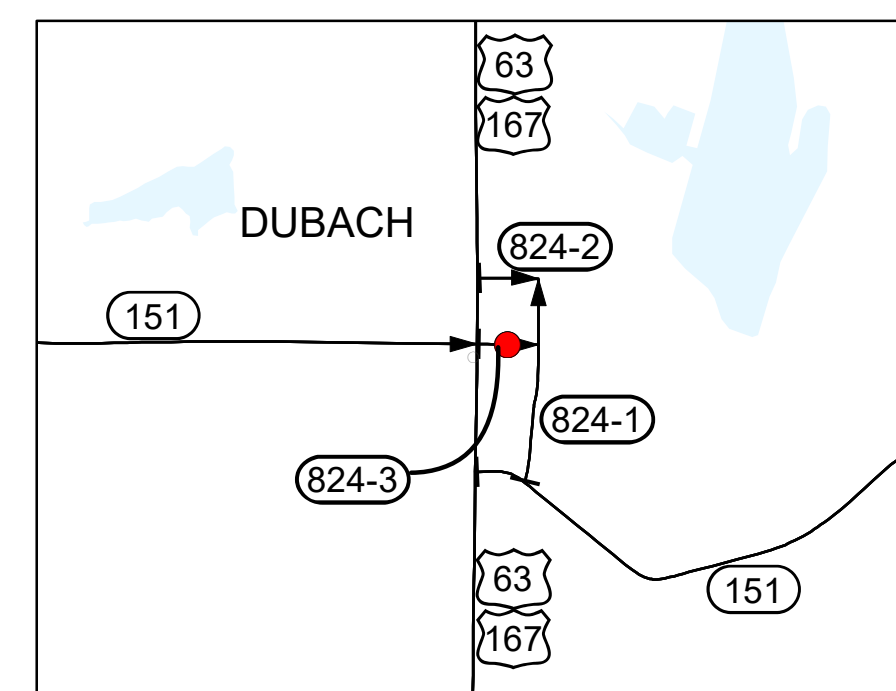

DUBACH

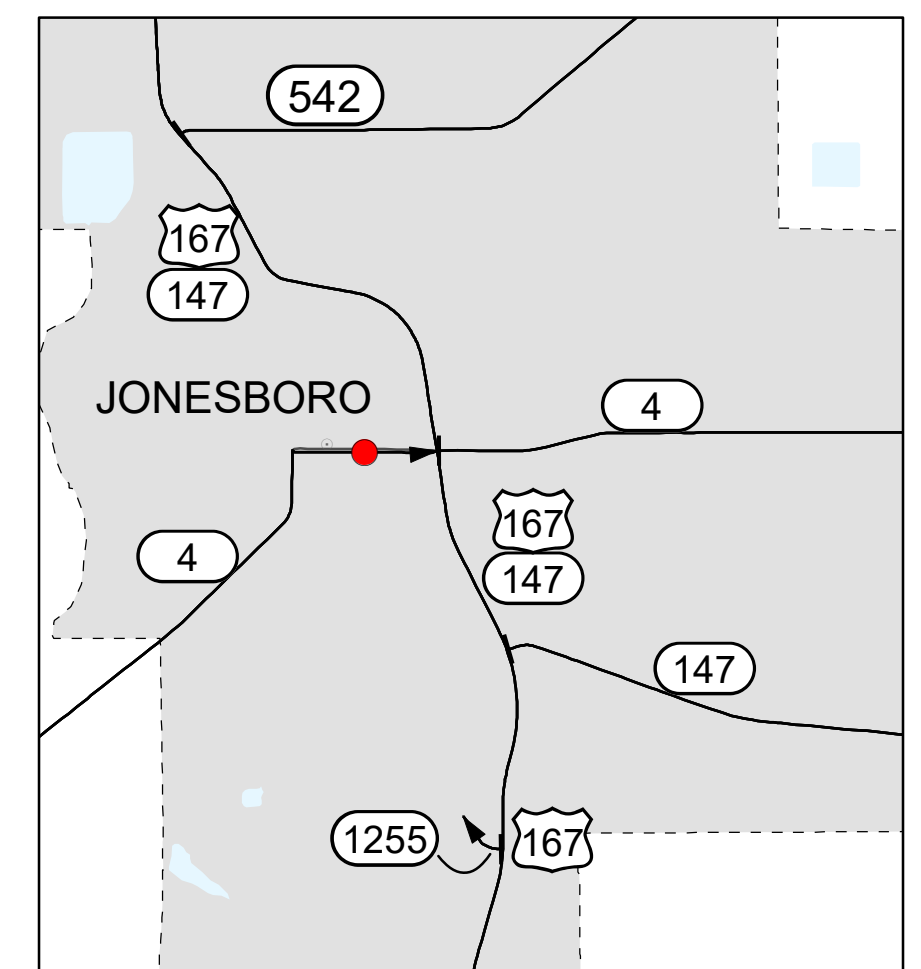

JONESBORO

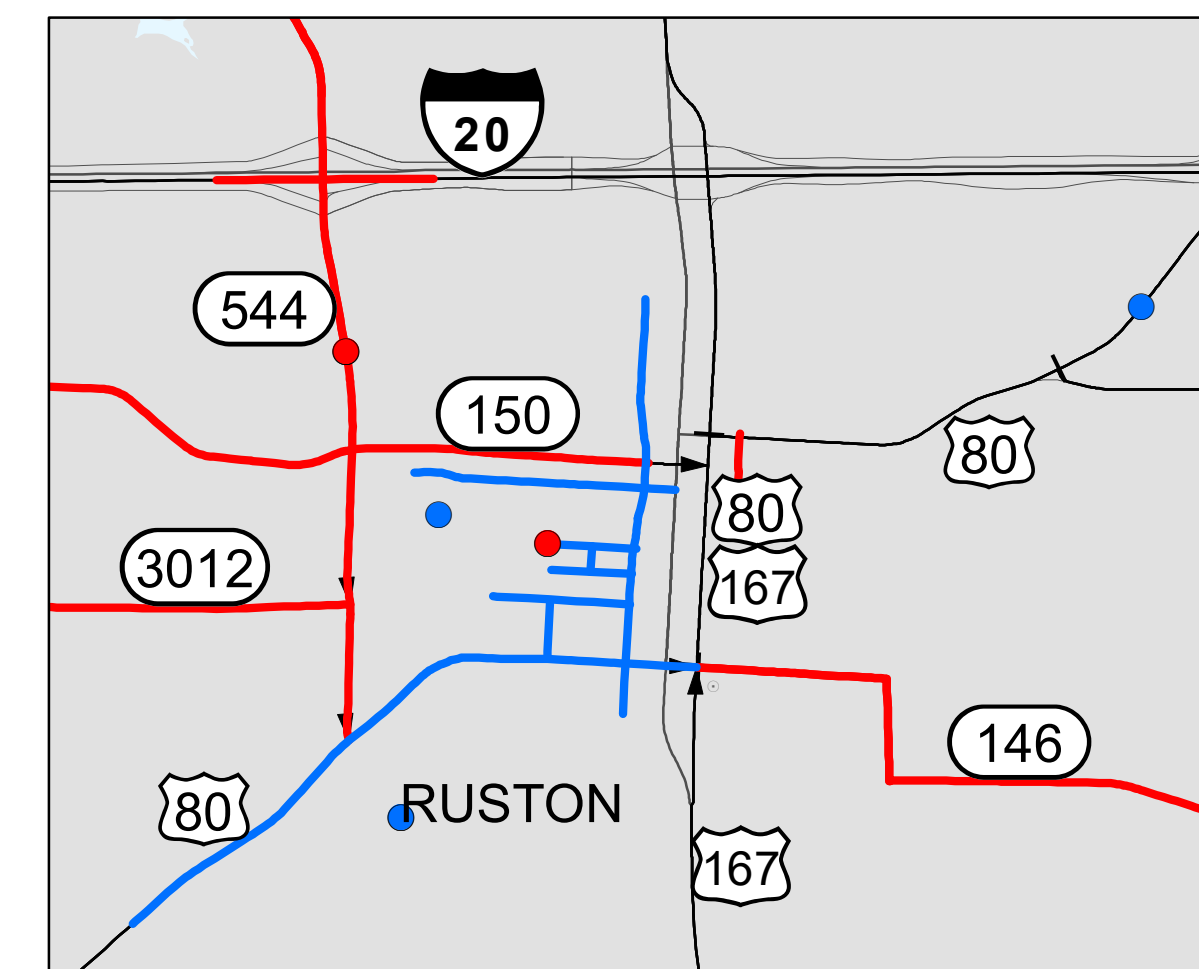

RUSTON

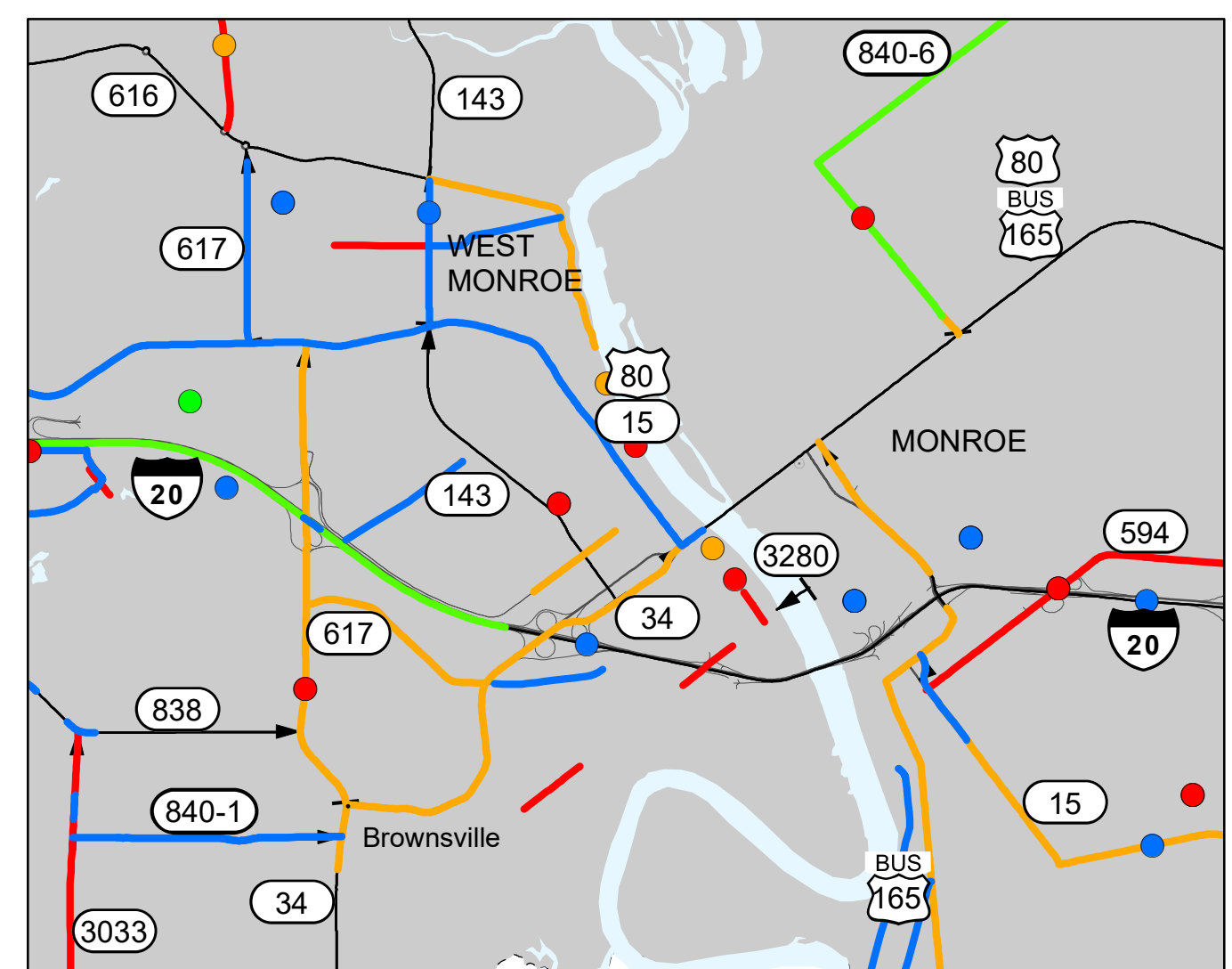

MONROE

- PARISH SEATS
- MUNICIPALITIES
- COMMUNITIES
- PROJECTS LET BETWEEN JULY 2019 AND SEPTEMBER 2024
- PROJECTS TO BE LET BETWEEN OCTOBER 2024 AND JUNE 2025
- PROJECTS SCHEDULED TO BE LET IN SFY 25-26 (Next Fiscal Year)
- OTHER PROJECTS BEING DEVELOPED
- CONTROL SECTIONS / STATE ROUTES
- ..... PROPOSED ROADS
- FERRY BOATS
- PARISH LINES
- URBANIZED AREAS
- URBAN AREAS

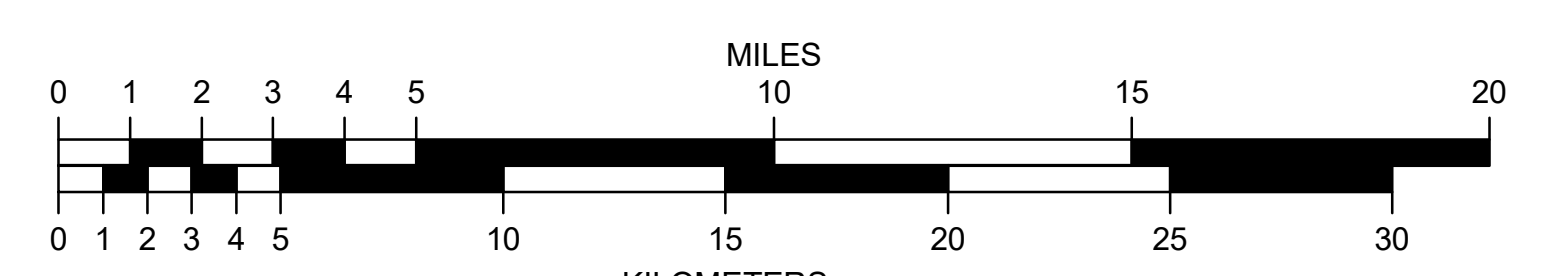
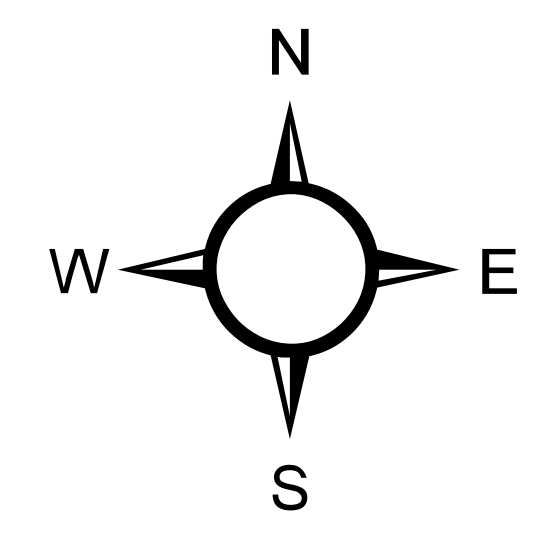

Map Updated: October 2024

## MAPS FOR LEGISLATIVE PUBLIC HEARINGS FOR SFY 2025-2026 HIGHWAY PRIORITY PROGRAM DISTRICT 05

THIS MAP HAS BEEN PREPARED BY THE LOUISIANA DEPARTMENT OF TRANSPORTATION AND DEVELOPMENT OFFICE OF PLANNING AND GIS MAPPING UNIT IN COOPERATION WITH THE U.S. DEPARTMENT OF TRANSPORTATION - FEDERAL HIGHWAY ADMINISTRATION. PRINTED COPIES OF THIS MAP ARE AVAILABLE FOR PUBLIC USE AT A NOMINAL COST. PLEASE SEE THE FOLLOWING CONTACT INFORMATION: DEPARTMENT OF TRANSPORTATION AND DEVELOPMENT SECTION 26, ENTERPRISE SUPPORT SERVICES. RMJ - MAP SALES P.O. BOX 9245 BATON ROUGE, LA 70804-9245 (225) 379-1107 or (225) 379-1190

DATA ON THIS MAP IS PREPARED BY GIS PROFESSIONALS INTENDED FOR INTERNAL PLANNING USE ONLY. ALTHOUGH THIS DATA IS NOT SURVEY GRADE, IT HAS BEEN SUBMITTED TO MANY RIGOROUS TESTS - ALL WITH EXCELLENT RESULTS - NO WARRANTY, EXPRESSED OR IMPLIED, IS MADE AS TO THE ACCURACY OF THE DATA. NOR SHALL THE FACT OF DISTRIBUTION CONSTITUTE ANY SUCH WARRANTY. DOTD ASSUMES NO LIABILITY IN ANY CONNECTION THEREWITH, AND ASSUMES NO RESPONSIBILITY TO DISTRIBUTE FUTURE MODIFICATIONS OR CORRECTIONS THAT MAY BE MADE.

PROJECTION: NAD 1983 UTM Zone 15N  
Transverse Mercator  
False Sighting: 500000.000000  
False Northing: 0.000000  
Central Meridian: -93.000000  
Scale Factor: 0.999600  
Latitude Of Origin: 0.000000  
HORIZONTAL DATUM: NORTH AMERICAN DATUM OF 1983